

CITY OF CIMARRON

CITY OFFICE ONLY _____ Prelim Approval _____ Preconstruction Approval _____ Final Approval	CITY OFFICE ONLY Permit # _____
--	---

STEPS FOR APPROVAL

1. CONSTRUCTION MUST MEET ALL REQUIREMENTS OF ZONING, BUILDING ELECTRIC, PLUMBING, AND GAS FITTING CODE AS ADOPTED BY THE CITY OF CIMARRON. ANY CONSTRUCTION NOT COMPLETED AS TO CODE WILL BE SUBJECT TO PENALTIES BY ORDINANCE.
2. SUBMITTING THE BUILDING PERMIT WITH LEGIBLE DRAWINGS IN PROPER DIMENSIONS SHOWING PROPER LOCATION OF PROPOSED IMPROVEMENTS WITH REFERENCES TO CURBS, PROPERTY LINES AND ALLEYS.
3. **BEFORE FIRST INSPECTION, PROPERTY LINES AND DESIGN OF CONSTRUCTION MUST BE FLAGGED.**
4. **DIG SAFE MUST BE CALLED BEFORE PRE-CONSTRUCTION INSPECTION. THIS IS THE RESPONSIBILITY OF THE OWNER OR CONTRACTOR.**
5. NOTIFYING THE CITY AFTER FORMS AND STEEL ARE IN PLACE, BUT BEFORE CONCRETE IS TO BE POURED WHEN IMPROVEMENTS CALL FOR THE POURING OF CONCRETE.

IMPORTANT - COMPLETE ALL ITEMS THAT APPLY

1. ADDRESS	NUMBER AND STREET	SUBDIVISION	LOT	BLOCK
------------	-------------------	-------------	-----	-------

<u>TYPE OF IMPROVEMENTS</u> COST PER SQUARE FOOT: \$ _____ <input type="checkbox"/> NEW BUILDING <input type="checkbox"/> ADDITION / ALTERATIONS <input type="checkbox"/> REPAIR / REPLACEMENT <input type="checkbox"/> CONCRETE / FOUNDATION <input type="checkbox"/> CONCRETE / BASEMENT <input type="checkbox"/> STORAGE SHED COST: \$ _____ <input type="checkbox"/> DECK <input type="checkbox"/> FENCE <input type="checkbox"/> FLAT CONCRETE <input type="checkbox"/> PORCH <input type="checkbox"/> MOVING <input type="checkbox"/> WRECKING * BASEMENT & FOUNDATION FIGURED IN ON THE COST OF HOUSE	<u>PUBLIC UTILITY - HOOK UPS-ESTIMATED COST BY CITY STAFF</u> ELECTRIC DISCONNECT <input type="checkbox"/> 100 AMP. \$ _____ <input type="checkbox"/> 150 AMP. \$ _____ <input type="checkbox"/> 200 AMP. \$ _____ <input type="checkbox"/> 3-PHASE COMMERCIAL \$ _____ SEWER <input type="checkbox"/> SEWER TAP \$ _____ WATER <input type="checkbox"/> 1" SERVICE \$ _____ <input type="checkbox"/> 1-1/2" SERVICE \$ _____ <input type="checkbox"/> 2" SERVICE \$ _____ ** ADDITION ELECTRICAL COSTS REFER TO: RESOLUTION NO. 206
---	---

<u>PRINCIPLE TYPE OF FRAME</u> <input type="checkbox"/> MASONRY (WALL BEARING) <input type="checkbox"/> OTHER <input type="checkbox"/> REINFORCED CONCRETE SPECIFY _____ <input type="checkbox"/> STEEL FRAME <input type="checkbox"/> WOOD FRAME	<u>TYPE OF MECHANICAL</u> WILL THERE BE CENTRAL AIR CONDITION YES <input type="checkbox"/> NO <input type="checkbox"/> AIR CONDITION 240 SINGLE ONLY IN RESIDENTIAL AREAS
--	---

<input type="checkbox"/> AMUSEMENT / RECREATIONAL <input type="checkbox"/> CHURCH, OTHER RELIGIOUS <input type="checkbox"/> INDUSTRIAL <input type="checkbox"/> PARKING GARAGE	NON - RESIDENTIAL <input type="checkbox"/> SERVICE STATION REPAIR GARAGE <input type="checkbox"/> HOSPITAL, INSTITUTIONAL <input type="checkbox"/> OFFICE, BANK, PROFESSIONAL <input type="checkbox"/> OTHER - SPECIFY _____	<input type="checkbox"/> STORES, MERCANTILE <input type="checkbox"/> TANKS, TOWERS <input type="checkbox"/> SCHOOL, LIBRARY, OTHER <input type="checkbox"/> EDUCATIONAL
Cost Per Square Foot: \$ _____		

DESCRIPTION OF WHAT YOUR DOING: _____

COMPLETION DATE: _____

IDENTIFICATION - TO BE COMPLETED BY APPLICANTS				
	NAME	MAILING ADDRESS NUMBER, CITY, AND STATE	ZIP CODE	TELEPHONE NUMBER
1. OWNER				
2. CONTRACTOR				

****The owner of this building and the undersigned agree to conform to all Ordinances, Policies and Resolutions City of Cimarron - Cimarron, Kansas**

Signature of Applicant: _____	Address: _____	Application Date _____
Approved by: _____	Council Initials: _____	

{ OVER }

1. Front Yard - Set Back 30' Off Property Line

2. Side Yard - Set Back 5' Off Property Line

3. Rear Yard [Alley] - Set Back 5' Off Property Line

[Or 10% Of The Lot]

4. Write Down Street Names & Locations On The Drawing

5. Draw In Alley Location

6. Measurements Required From All Sides

* Coverants Require Different Set Backs



Example Drawing Only - On A Corner Lot

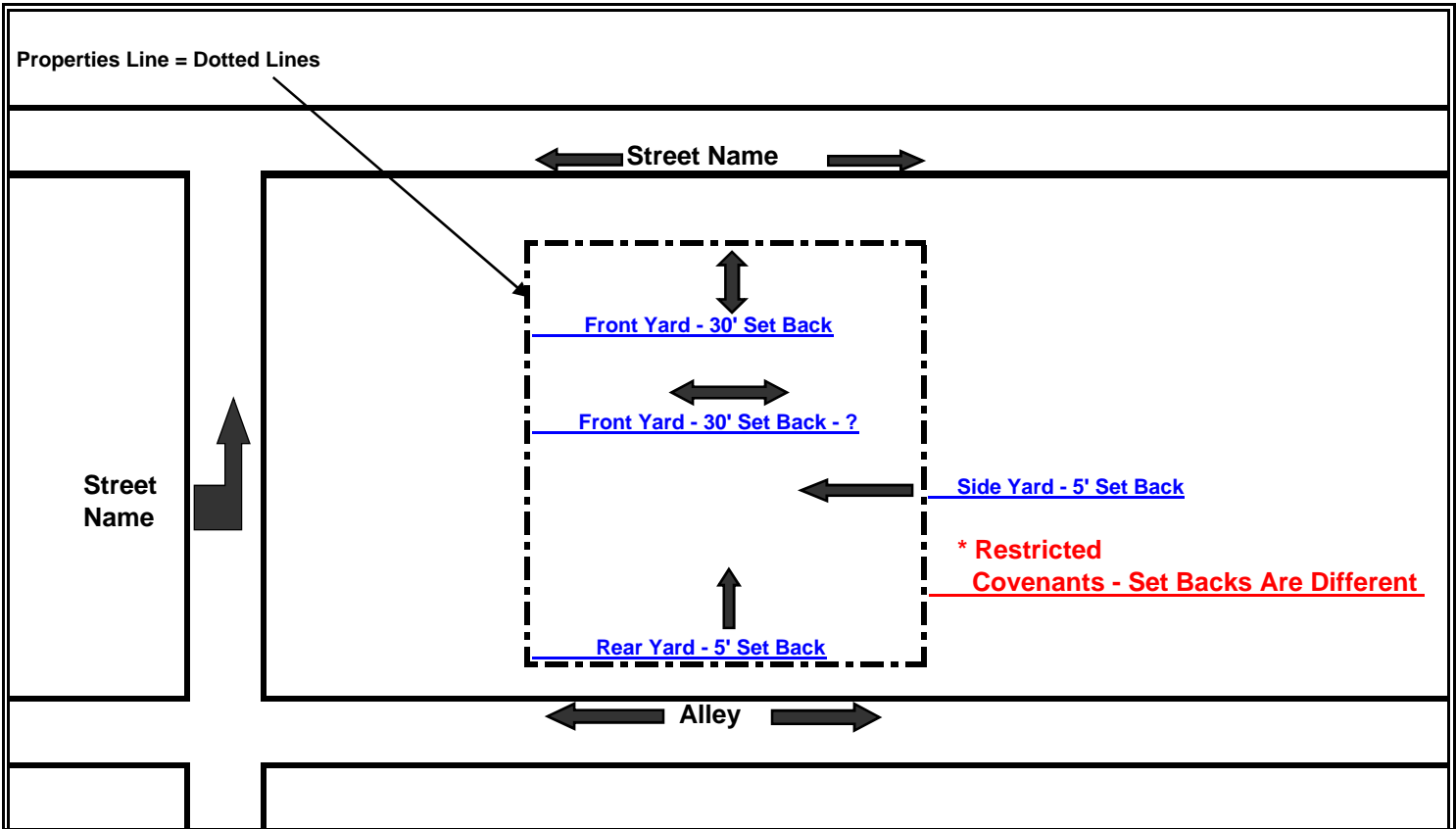

Example Drawing Only - On A Lot

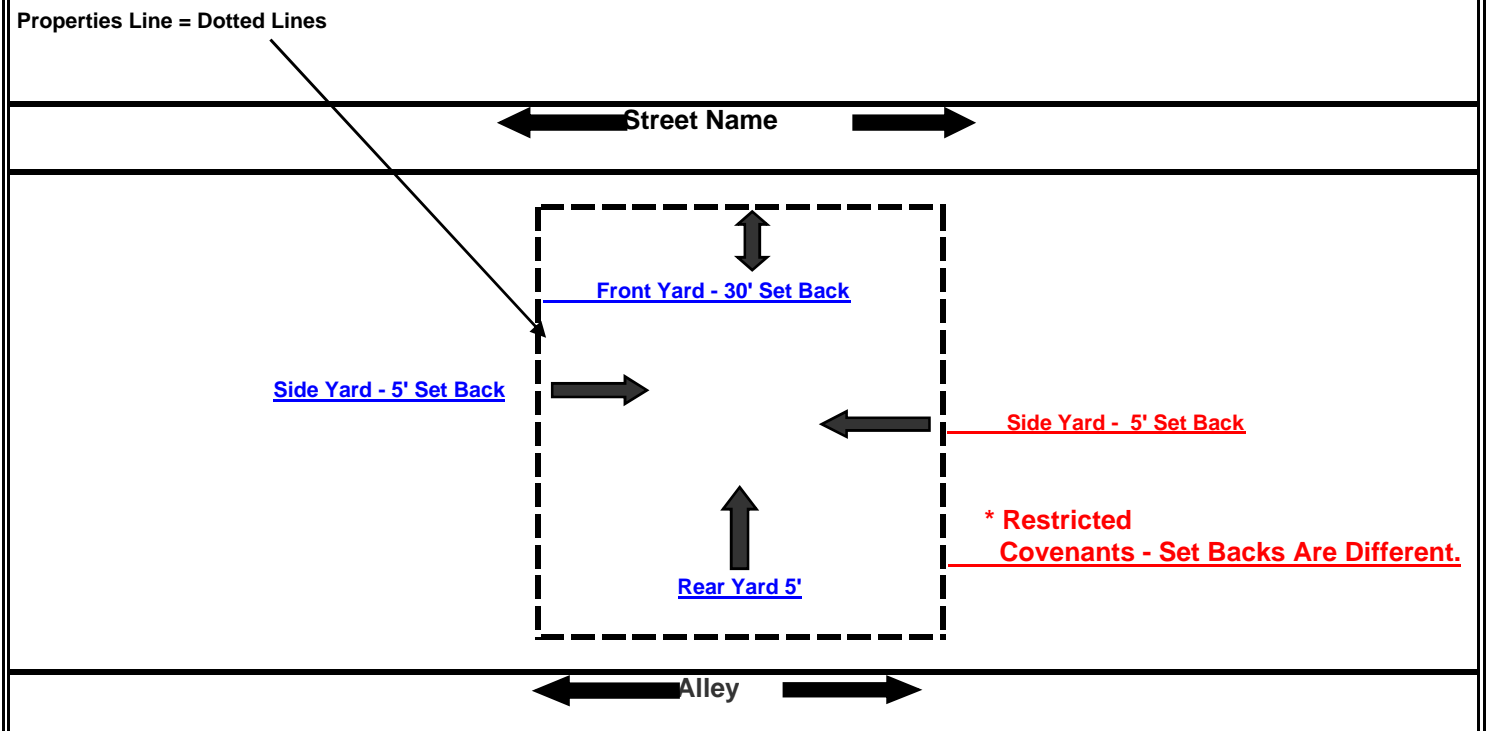

**** Do Not Measure From The Center Of The Street Or From The Back Of The Curb ****
All City Streets May Not Be Centered In The Street Right Of Way